

PACK LOADS OF **SUMMER COLOR** INTO YOUR GARDEN

Garden Gate®

GardenGateMagazine.com

TIME-**SAVING** GARDEN TIPS

**WINTER
GARDEN
SURVIVAL
GUIDE!**

14 PLANTS
GUARANTEED
TO BRING IN MORE
HUMMINGBIRDS

EXCLUSIVE: 9 EASY PLANTS.
1 COLORFUL DESIGN.

4 PROS' TIPS
FOR BETTER SOIL

**LONG BLOOMING,
EASY CARE**

—this perennial has it all!

**PLUS: Need-to-Know
Houseplant Troubleshooting Tips**

November/December 2019

\$7.99US \$8.99CAN 12>



0 92567 39134 9

Display until December 17, 2019

A small tree planted in the front yard off the corner of the house is a great way to counteract a house's hard angles.

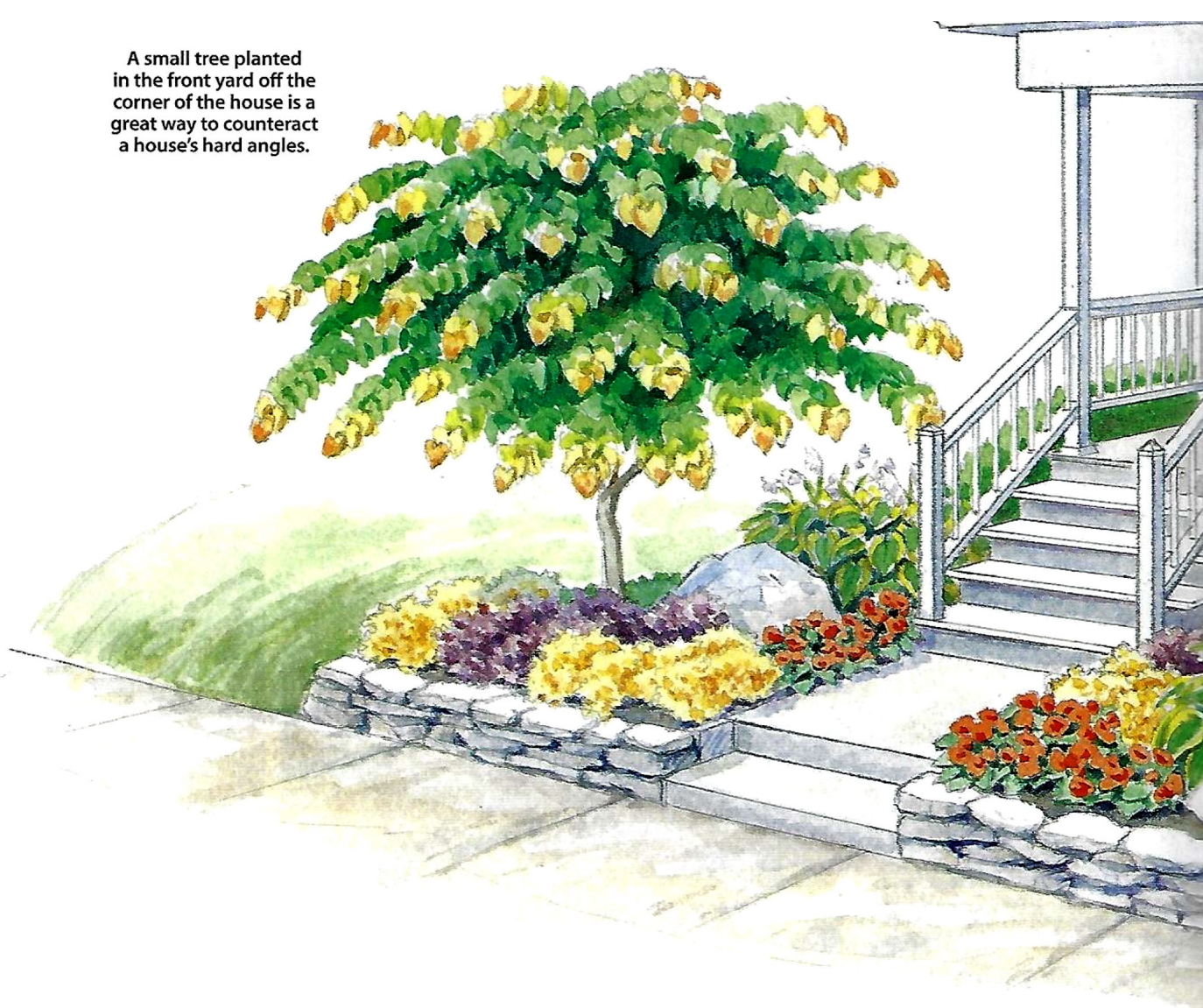

Easy-care front entry

Mowing a sloping front yard can be difficult, and if you have a shady east-facing space, turf may struggle anyway. Make it prettier and easier to maintain when you put in a planting like this one.

Start with a low stone wall to help level the garden area. This will ensure that plants and soil stay in place and prevent mulch from regularly washing out onto the sidewalk. Next, plant the trees and shrubs. The Eastern redbud and Japanese maple will screen the porch, but not too much. And they create a great view *from* the porch, as well: Both cultivars have beautiful foliage that changes color throughout the seasons. The foundation planting of mountain laurels is just the right height to dress up the porch skirt but not so tall that they block views.

Light and bright-colored flowers add life to a shade garden. Here it's perennial white astilbes and tender orange tuberous begonias, which are planted both in the ground and in hanging baskets on the porch.

Learn how to grow these plants on the next page.

PLANT LIST (number to plant)

- A Eastern redbud** *Cercis canadensis* The Rising Sun™ (1)
- B Japanese maple** *Acer palmatum* 'Amber Ghost' (1)
- C Mountain laurel** *Kalmia latifolia* 'Elf' (6)
- D Hosta** *Hosta* 'Afterglow' (4)
- E Log fern** *Dryopteris celsa* (5)
- F Chinese astilbe** *Astilbe chinensis* 'Vision in White' (10)
- G Coral bells** *Heuchera* 'Black Taffeta' (13)
- H Coral bells** *Heuchera* 'Ginger Ale' (24)
- I Tuberous begonia** *Begonia x tuberhybrida* Nonstop® Mocca Deep Orange (21)
- J Sweet woodruff** *Galium odoratum* (96)

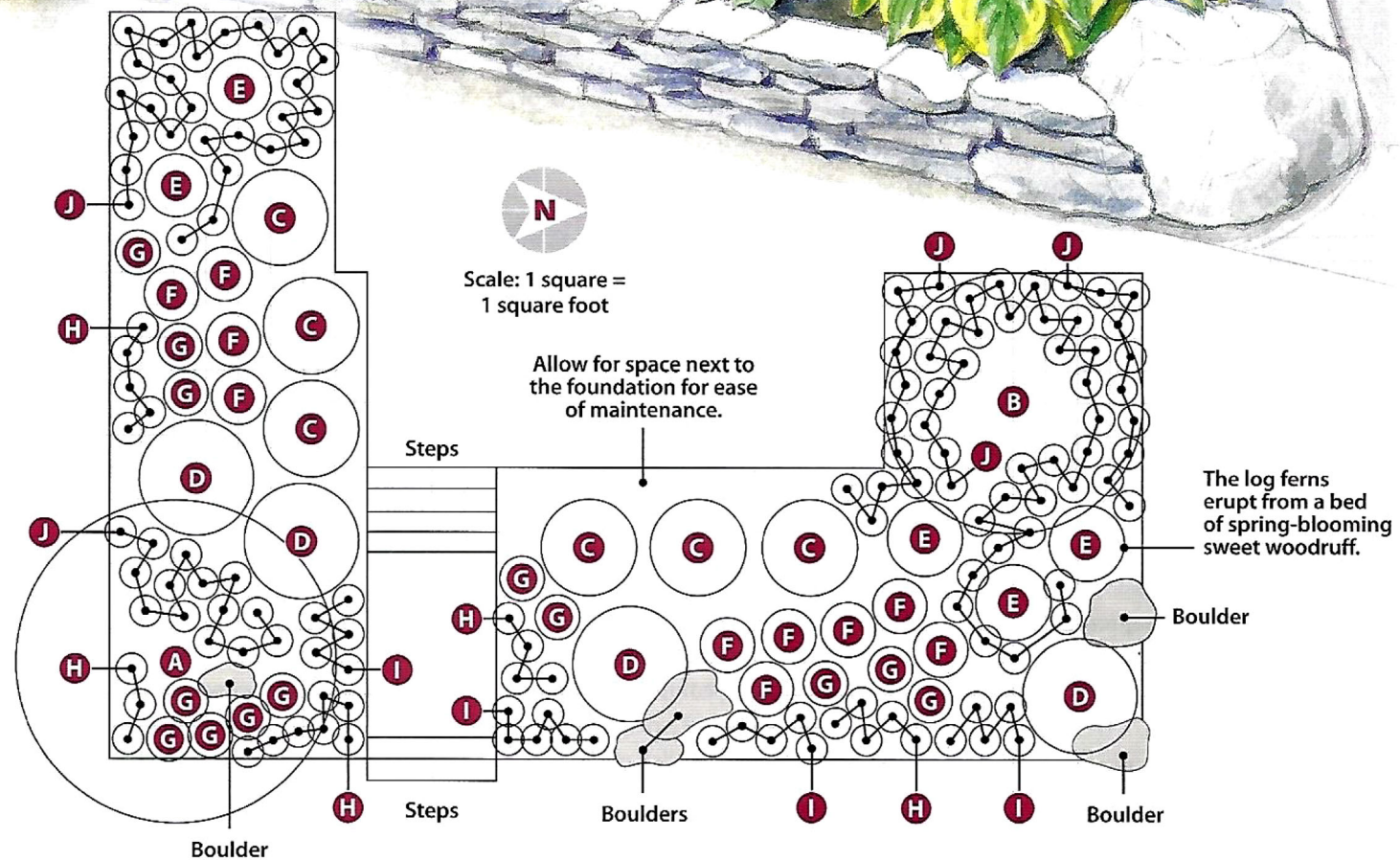

Meet the plants

The part shade of an eastern exposure is the perfect spot for this collection of plants. There you'll still get plenty of blooms, but won't have to deal with sunburn and frequent watering, as you would in full sun.

Start in spring with a quick cleanup. Examine the trees and shrubs for any broken or cold-damaged branches and prune them off cleanly. Then cut off the dead perennial stems and rake the beds clean, reapplying mulch if needed.

Flowers will start appearing by midspring. And as soon as the risk of frost is past, you can plant your begonias. Deadheading isn't necessary for these plants, although the coral bells and astilbe will look tidier if you snip spent flower stems off below the foliage. When fall arrives, pull the tuberous begonias, but leave the foliage of the perennials to protect the crowns until spring.



A Redbud

Cercis canadensis The Rising Sun™

Tree; pink spring flowers, orange-peach new foliage ages to green and turns yellow in fall; full sun to part shade; 8 to 12 ft. tall, 8 to 15 ft. wide; cold zones 5 to 9



E Log fern

Dryopteris celsa

Perennial; upright, lacy leaves; full to part shade; 36 to 48 in. tall, 18 to 30 in. wide; cold zones 5 to 9



F Chinese astilbe

Astilbe chinensis 'Vision in White'

Perennial; white plumes in summer; full sun to part shade; 20 to 24 in. tall, 12 to 24 in. wide; cold zones 4 to 9



G Coral bells

Heuchera 'Black Taffeta'

Perennial; white blooms in early summer, dark burgundy, ruffy leaves; full sun to part shade; 10 to 21 in. tall, 12 to 15 in. wide; cold zones 4 to 9



B Japanese maple

Acer palmatum 'Amber Ghost'

Tree; new foliage is amber-pink with pronounced veining, aging to green-amber then red-orange in fall; full sun to part shade; 10 to 15 ft. tall, 8 to 10 ft. wide; cold zones 5 to 9

C Mountain laurel

Kalmia latifolia 'Elf'

Shrub; pink buds open white in spring, evergreen foliage; full sun to part shade; 2 to 3 ft. tall, 2 to 4 ft. wide; cold zones 4 to 8

D Hosta

Hosta 'Afterglow'

Perennial; lavender blooms in summer, yellow leaf margins and corrugated leaves; part to full shade; 2 to 3 ft. tall, 3 to 4 ft wide; cold zones 3 to 9

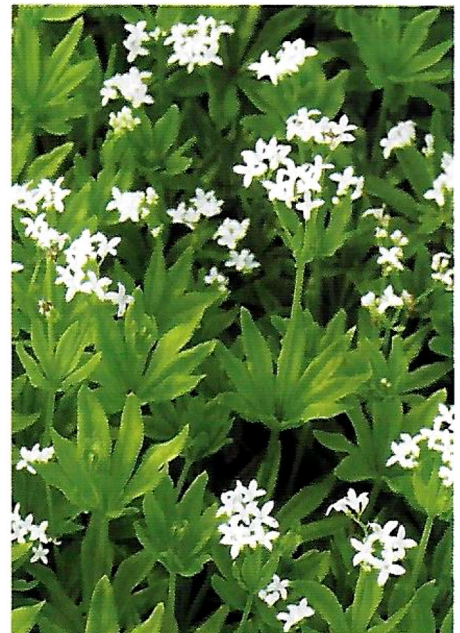
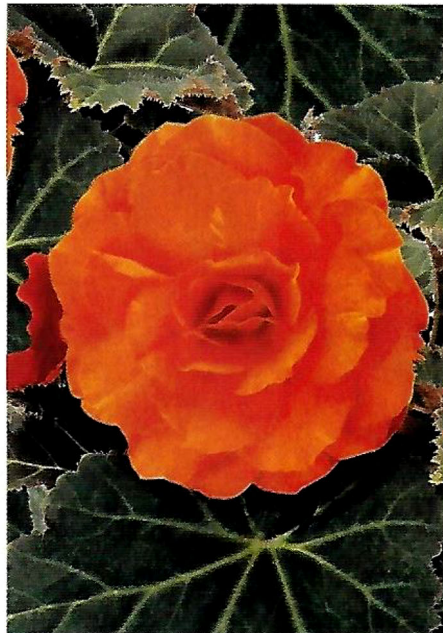

H Coral bells

Heuchera 'Ginger Ale'

Perennial; yellow-pink blooms in early summer, yellow-gold foliage with silvery overlay; full sun to part shade; 6 to 22 in. tall, 12 to 18 in. wide; cold zones 4 to 9

I Tuberous begonia

Begonia x tuberhybrida Nonstop®

Mocca Deep Orange
Tender perennial; bright-orange flowers from spring to fall, dark burgundy-green foliage; full sun to part shade; 8 to 12 in. tall, 12 to 14 in. wide; cold zones 9 to 11

J Sweet woodruff

Galium odoratum

Perennial; lightly fragrant white spring flowers; part to full shade; 6 to 12 in. tall, 12 to 15 in. wide; cold zones 4 to 8